

SHEET-METAL EXPANSION JOINT COVER WITH T-TYPE CLEAT

FLEXIBLE WEATHERPROOF MEMBRANE CLOSURE

FLEXIBLE LINER TO SERVE AS INSULATION RETAINER (ATTACHED TO TOP OF CURB)

TOP OF CURB TO DRAIN TO ONE SIDE

8" MINIMUM FLASHING HEIGHT ON LOW SIDE

SLOPE

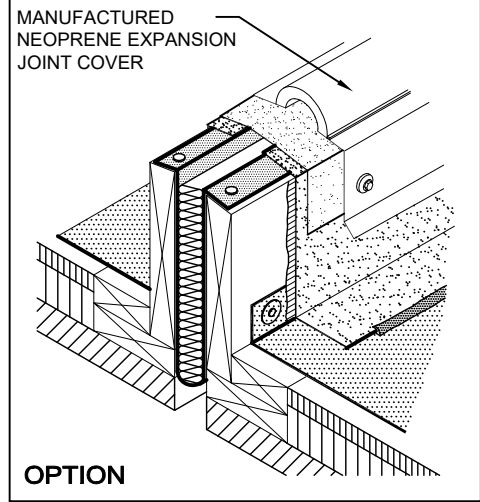

OPTION

STRONGHOLD FLASHING MEMBRANE ADHERED IN STRONGHOLD BONDING ADHESIVE

HOT-AIR-WELDED SEAM

STRONGHOLD EDGE SEALANT

STRONGHOLD BONDING ADHESIVE

EXTEND THE FIELD MEMBRANE 3" ABOVE THE ROOF SURFACE ONTO THE VERTICAL FLASHING SUBSTRATE.

MECHANICALLY ATTACH WITH APPROPRIATE FASTENERS ON 12" CENTERS.

COMPRESSIBLE INSULATION

2 x 6 MIN. WOOD NAILER ATTACHED TO SUBSTRATE— OVERALL THICKNESS TO MATCH INSULATION

NOTES:

1. STRONGHOLD FLEECE-BACK MEMBRANE, APPLIED IN A SPATTER COAT OF STRONGHOLD FOAMABLE OR PUMP GRADE ADHESIVE MAY BE SUBSTITUTED FOR SMOOTH MEMBRANE IN BONDING ADHESIVE.
2. REFER TO THE ARCHITECTURAL METAL FLASHING SECTION OF THE NRCA ROOFING MANUAL: ARCHITECTURAL METAL FLASHING AND CONDENSATION AND AIR LEAKAGE CONTROL FOR DESIGN AND SECUREMENT OPTIONS FOR COUNTERFLASHINGS.

STRONGHOLD™

EXPANSION JOINT - ROOF-TO-ROOF

#2 Industrial Park Drive · PO Box 497 · Morrilton, AR 72110
Customer Service: (800) 535-8597 · Fax: (501) 354-3019 · www.bitec.com

BITEC®
WHEN QUALITY MATTERS™

NOT DRAWN TO SCALE

Reference: SH-EJ-RTR

Rev. 11/2025 © BITEC, Inc.